



# DROP FORGED EYE NUTS

Stock Eye Nuts listed below, other than Blanks, are drilled and tapped standard regardless of finish. Both types drilled only, with special tapping or finish supplied to specification. Loads are based on a design factor of 5 to 1. Blanks are self-colored.

**NOTE:** Loads shown apply to Eye Nuts only, based on a vertical pull, and not to any connecting bolt or stud.

- Meets or exceeds all requirements of ASME B30.26 including identification, ductility, design factor, proof load and temperature requirements.
- Material traceability available through Product Identification Code (PIC) System

## REGULAR EYE NUTS



Regular

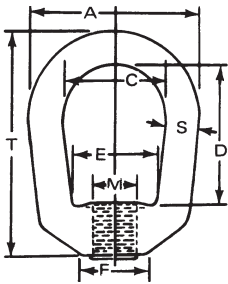

Stock No.	Bail Size	Tap Size	Drilled & Tapped			Blank Part No.
			Self-Colored Part No.	Hot Galvanized Part No.	Working Load Limit (Lbs)	
C-186A	1/4"	1/4"-20	16255 5	16755 5	520	16005 6
C-186B	1/4"	5/16"-18	16260 9	16760 9	840	16010 0
C-187A	5/16"	3/8"-16	16265 4	16765 9	1240	16015 5
C-185B	3/8"	7/16"-14	16270 8	16770 8	1700	16020 9
C-185A	3/8"	1/2"-13	16275 3	16775 8	2240	16025 4
C-181A	1/2"	5/8"-11	16280 7	16780 2	3600	16030 8
C-184A	5/8"	3/4"-10	16285 2	16785 7	5200	16035 3
C-188A	3/4"	7/8"-9	16290 6	16790 1	7200	16040 7
C-188B	3/4"	1"-8	16295 1	16795 6	7200	16045 2

## REGULAR EYE NUTS - METRIC

Stock No.	Metric Size	Bail Size	Thread Size	Self-Colored Part No.	Hot Galvanized Part No.	Working Load Limit (Lbs)
C-186A	M6	1/4"	M6 x 1.0	14970 9	14980 8	350
C-186B	M7	1/4"	M7 x 1.0	14971 6	14981 5	500
C-187A	M8	5/16"	M8 x 1.25	14972 3	14982 2	650
C-185B	M10	3/8"	M10 x 1.5	14973 0	14983 9	800
C-185A	M12	3/8"	M12 x 1.75	14974 7	14984 6	1700
C-181A	M16	1/2"	M16 x 2.0	14975 4	14985 3	2500
C-184A	M18	5/8"	M18 x 2.5	14976 1	14986 0	3000
C-188A	M20	3/4"	M20 x 2.5	14977 8	14987 7	3500
C-188B	M24	3/4"	M24 x 3.0	14978 5	14988 4	5000

Some sizes also available in Stainless Steel. See page 42.



## SPECIFICATIONS

Stock No.	Tap Sizes		Dimensions - Inches							Drilled & Tapped Wgt. Per 100	Blank Wgt. Per 100
	Std. M	Max. N	A	C	D	E	F	S	T		
C-186A	1/4"-20	3/8"	1-1/4"	3/4"	1-1/16"	19/32"	1/2"	1/4"	1-11/16"	8.2	9
C-186B	5/16"-18	3/8"	1-1/4"	3/4"	1-1/16"	19/32"	1/2"	1/4"	1-11/16"	8	9
C-187A	3/8"-16	7/16"	1-5/8"	1"	1-1/4"	3/4"	9/16"	5/16"	2-1/16"	15.7	16
C-185B	7/16"-14	1/2"	2"	1-1/4"	1-1/2"	1"	13/16"	3/8"	2-1/2"	29.7	31
C-185A	1/2"-13	1/2"	2"	1-1/4"	1-1/2"	1"	13/16"	3/8"	2-1/2"	29.3	31
C-181A	5/8"-11	3/4"	2-1/2"	1-1/2"	2"	1-3/16"	1"	1/2"	3-3/16"	61.5	66
C-184A	3/4"-10	7/8"	3"	1-3/4"	2-3/8"	1-3/8"	1-1/8"	5/8"	3-7/8"	103	112
C-188A	7/8"-9	1"	3-1/2"	2"	2-5/8"	1-5/8"	1-5/16"	3/4"	4-5/16"	163	183
C-188B	1"-8	1"	3-1/2"	2"	2-5/8"	1-5/8"	1-5/16"	3/4"	4-5/16"	161	183

# DROP FORGED HEAVY DUTY EYE NUTS



Stock Eye Nuts listed below, other than Blanks, are drilled and tapped standard regardless of finish. Both types drilled only, with special tapping or finish supplied to specification. Loads are based on a design factor of 5 to 1. Self-colored finish is standard.

**NOTE:** Loads shown apply to Eye Nuts only, based on a vertical pull, and not to any connecting bolt or stud.



## SELF-COLORED – BLANK OR DRILLED AND TAPPED

Stock No.	Bail Size	Drilled & Tapped			Blank Part No.
		Tap Size	Part No.	Working Load Limit (Lbs)	
100	5/16"	3/8"-16	17255 4	1800	17005 5
101	7/16"	1/2"-13	17260 8	3600	17010 9
102	9/16"	5/8"-11	17265 3	5800	17015 4
103	3/4"	3/4"-10	17270 7	10600	17020 8
104	7/8"	7/8"-9	17275 2	14400	17025 3
105	1"	1"-8	17280 6	18800	17030 7
105A	1"	1-1/8"-7	17285 1	22600	17035 2
106	1-1/4"	1-1/4"-7	17290 5	29400	17040 6
107	1-3/8"	1-1/2"-6	17295 0	35600	17045 1



Blank



Drilled & Tapped

## METRIC HEAVY DUTY DROP FORGED EYE NUTS

Stock No.	Metric Size	Bail Size	Thread Size	Part No.	Working Load Limit (Lbs)
100	M8	5/16"	M8 x 1.25	17155 7	1100
101	M12	7/16"	M12 x 1.75	17160 1	2300
102	M16	9/16"	M16 x 2.0	17165 6	3700
103	M18	3/4"	M18 x 2.5	17170 0	6000
104	M20	7/8"	M20 x 2.5	17175 5	7600
105	M24	1"	M24 x 3.0	17180 9	11000
106	M30	1-1/4"	M30 x 3.5	17185 4	14000
107	M36	1-3/8"	M36 x 4.0	17190 8	19000

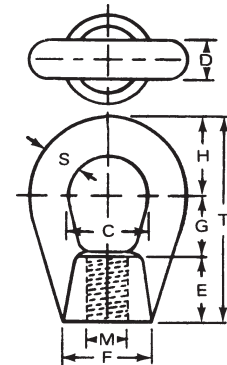

## SPECIFICATIONS

Stock No.	Dimensions – Inches									Drilled & Tapped Wgt. Per 100	Blank Wgt. Per 100
	C	S	D	M	F	E	G	H	T		
100	7/8"	5/16"	5/16"	3/8-16"	3/4"	3/4"	3/4"	3/4"	2-1/4"	15	16
101	1-1/8"	7/16"	7/16"	1/2-13"	1"	1"	1"	1"	3"	37.5	43
102	1-3/8"	9/16"	9/16"	5/8-11"	1-1/4"	1-1/4"	1-1/4"	1-1/4"	3-3/4"	82.5	94
103	1-1/2"	3/4"	3/4"	3/4-10"	1-3/4"	1-1/4"	1-1/8"	1-1/2"	3-7/8"	145	160
104	1-5/8"	7/8"	7/8"	7/8-9"	2"	1-1/4"	1"	1-11/16"	3-15/16"	202.5	210
105	1-3/4"	1"	1"	1-8"	2-1/4"	1-5/8"	1-1/4"	1-7/8"	4-3/4"	327.5	340
105A	1-3/4"	1"	1"	1-1/8-7"	2-1/4"	1-5/8"	1-1/4"	1-7/8"	4-3/4"	297	340
106	2"	1-1/4"	1-1/4"	1-1/4-7"	2-7/8"	1-7/8"	1-3/8"	2-1/4"	5-1/2"	550	623
107	2-1/2"	1-3/8"	1-3/8"	1-1/2-6"	3-1/8"	2-1/8"	1-3/4"	2-5/8"	6-1/2"	807.5	919