



DROP FORGED BLANK ROD ENDS

Drop forged. Listed diameters and lengths carried in stock blank, self-colored. Drilling, threading, other machining and plating furnished to specification.

NOTE: Average properties of 1035 natural hot rolled steel 75/85,000 lbs. P.S.I. tensile, 40/55,000 lbs. P.S.I yield.

DROP FORGED BLANK ROD ENDS

Some sizes also available in Stainless Steel. See page 40.



Stock No.	Part No.	Dimensions – Inches				Weight Per 100
		Shank Diameter (B)	Boss Diameter (C)	Boss Thickness (F)	*Length (A) in Inches	
C-134	18005 4	1/4"	1/2"	9/32"	3"	6.1
C-134-A	18010 8	1/4"	1/2"	9/32"	6"	11
C-135	18015 3	5/16"	5/8"	11/32"	3"	9.5
C-135-A	18020 7	5/16"	5/8"	11/32"	6"	18
C-163-A	18025 2	3/8"	11/16"	3/8"	2-1/8"	12
C-162	18030 6	3/8"	3/4"	3/8"	2-1/2"	12.5
C-217	18035 1	3/8"	3/4"	7/16"	3"	14
C-136	18040 5	3/8"	3/4"	7/16"	6"	25.5
C-137	18045 0	7/16"	7/8"	1/2"	6"	35
C-245	18050 4	1/2"	15/16"	9/16"	1-3/4"	22
C-163	18055 9	1/2"	15/16"	9/16"	3-1/8"	27.5
C-212	18060 3	1/2"	1"	9/16"	3-1/2"	30
C-138	18065 8	1/2"	1"	9/16"	6"	47
C-195	18070 2	1/2"	1"	9/16"	10"	70
C-189	18075 7	5/8"	1-1/4"	11/16"	3"	45.5
C-303	18080 1	5/8"	1-3/16"	5/8"	3-1/2"	48
C-139	18085 6	5/8"	1-1/4"	11/16"	6"	77.5
C-172	18090 0	5/8"	1-1/4"	11/16"	8"	92
C-196	18095 5	5/8"	1-1/4"	11/16"	10"	119
C-216	18100 6	3/4"	1-1/2"	13/16"	3-1/2"	82
C-140	18105 1	3/4"	1-1/2"	13/16"	6"	112
C-197	18110 5	3/4"	1-1/2"	13/16"	10"	163.5
C-141	18115 0	7/8"	1-3/4"	15/16"	6"	164
C-211	18120 4	7/8"	1-3/4"	15/16"	12"	377
C-142	18125 9	1"	2"	1-1/16"	6"	216
C-142-A	18130 3	1"	2"	1-1/16"	12"	354
C-282	18135 8	1-1/4"	2-1/2"	1-5/16"	12"	595

MACHINED ROD ENDS

Use graphic below

Dimensions		Quantity
A		MATERIAL SPEC
B		FINISH
C		HEAT TREAT
F		
G		
T		

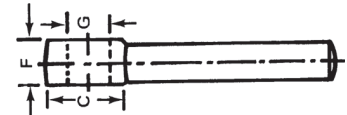
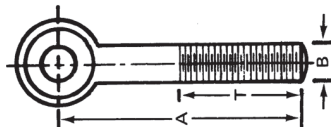

DROP FORGED PAD EYES

DROP FORGED PAD EYES

Stock No.	Part No.	Dimensions – Inches					Weight Per 100 in Lbs.
		Eye		Shoulder		*Overall Height	
		I.D.	O.D.	O.D.	*Thickness		
C-351	22005 7	1/4"	5/8"	5/8"	3/32"	3/4"	3.3
C-350	22010 1	3/4"	1-1/2"	1-1/16"	3/16"	1-5/8"	18.6
C-155	22015 6	1-3/16"	2-1/16"	1-11/16"	3/16"	2-3/8"	49
C-169	22020 0	1-1/4"	2-3/8"	2"	3/16"	2-7/8"	81



- Forged from carbon steel suitable for welding.
- Supplied with self-colored finish.
- Reference American Welding Society specifications for proper welding procedures.
- *Not including draft.

BLACK OXIDE MACHINED ROD ENDS



Drop forged. Listed diameters, lengths, thread lengths and hole sizes carried in stock. Drilling, threading, other machining and plating furnished to specification.

NOTE: Average properties of 1035 natural hot rolled steel 75/85,000 lbs. P.S.I. tensile, 40/55,000 lbs. P.S.I. yield.

Part No.	Thread Pitch	Dimensions – Inches					Weight Per 100
		Length in Inches (A)*	Thread Length (T)	Hole I.D. (G)	Boss Diameter (C)	Boss Thickness (F)	
18205 8	1/4"-20	2"	3/4"	3/16"	1/2"	9/32"	4
18206 5	1/4"-20	2"	3/4"	1/4"	1/2"	9/32"	4
11656 5	1/4"-20	3"	3/4"	3/16"	1/2"	9/32"	4
18207 2	1/4"-20	3"	3/4"	1/4"	1/2"	9/32"	4
11525 4	1/4"-20	4"	3/4"	3/16"	1/2"	9/32"	5
18208 9	1/4"-20	4"	3/4"	1/4"	1/2"	9/32"	5
11575 9	5/16"-18	3"	1-1/2"	1/4"	5/8"	11/32"	8
18210 2	5/16"-18	3"	1-1/2"	5/16"	5/8"	11/32"	8
11695 4	5/16"-18	4"	2"	1/4"	5/8"	11/32"	9
11627 5	5/16"-18	4"	2"	5/16"	5/8"	11/32"	9
18215 7	3/8"-16	3"	1-1/2"	5/16"	3/4"	7/16"	12
18220 1	3/8"-16	3"	1-1/2"	3/8"	3/4"	7/16"	12
18225 6	3/8"-16	3-3/4"	2"	3/8"	3/4"	7/16"	14
18230 0	3/8"-16	4"	1-1/2"	3/8"	3/4"	7/16"	16
18235 5	3/8"-16	5"	2-1/2"	3/8"	3/4"	7/16"	18
18245 4	1/2"-13	3-3/4"	1-1/2"	3/8"	1"	9/16"	29
18250 8	1/2"-13	4"	1-1/2"	3/8"	1"	9/16"	30
18251 5	1/2"-13	4"	1-1/2"	1/2"	1"	9/16"	30
18240 9	1/2"-13	5"	1-1/2"	3/8"	1"	9/16"	36
18255 3	1/2"-13	5"	2"	3/8"	1"	9/16"	36
11554 4	1/2"-13	6"	1-1/2"	3/8"	1"	9/16"	42
18260 7	5/8"-11	4-1/2"	2"	5/8"	1-1/4"	11/16"	50
18265 2	5/8"-11	5"	1-3/4"	5/8"	1-1/4"	11/16"	55
11598 8	5/8"-11	6"	1-3/4"	5/8"	1-1/4"	11/16"	63
18270 6	5/8"-11	6"	2-1/2"	5/8"	1-1/4"	11/16"	63
11580 3	5/8"-11	7"	1-3/4"	5/8"	1-1/4"	11/16"	70
11700 5	5/8"-11	8"	1-3/4"	5/8"	1-1/4"	11/16"	78
18280 5	3/4"-10	4-1/2"	2"	3/4"	1-1/2"	13/16"	77
11661 9	3/4"-10	5"	1-3/4"	5/8"	1-1/2"	13/16"	83
11522 3	3/4"-10	6"	1-3/4"	5/8"	1-1/2"	13/16"	95
18275 1	3/4"-10	6"	2-1/2"	3/4"	1-1/2"	13/16"	95
11701 2	3/4"-10	7"	1-3/4"	5/8"	1-1/2"	13/16"	107
11517 9	3/4"-10	8"	1-3/4"	5/8"	1-1/2"	13/16"	119
11688 8	7/8"-9	6"	2"	3/4"	1-3/4"	15/16"	146
18290 4	7/8"-9	6"	2"	7/8"	1-3/4"	15/16"	146
11702 9	7/8"-9	12"	4"	3/4"	1-3/4"	15/16"	250
11609 1	1"-8	6"	2"	7/8"	2"	1-1/16"	185
18300 0	1"-8	6"	2"	1"	2"	1-1/16"	185
11672 5	1"-8	12"	4"	7/8"	2"	1-1/16"	325
11670 1	1-1/4"-7	6"	2-1/2"	1-1/8"	2-1/2"	1-5/16"	315
11632 9	1-1/4"-7	12"	4-1/2"	1-1/8"	2-1/2"	1-5/16"	545

* Measured from center of boss

